



199

LEAF HINGE



LH/RH

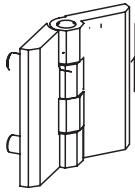
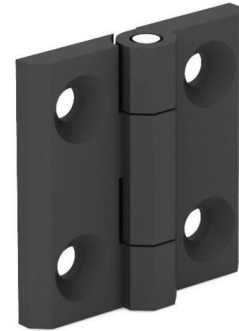

V : 1

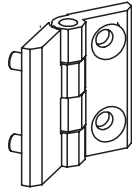

V : 2

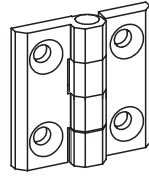

V : 3

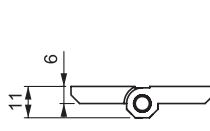
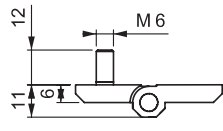
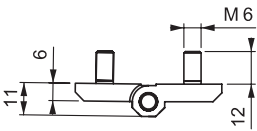
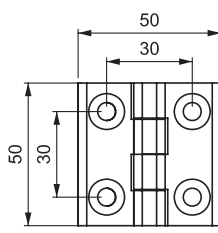
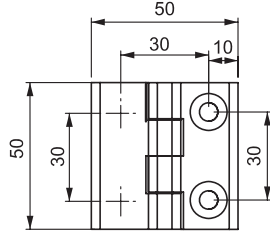
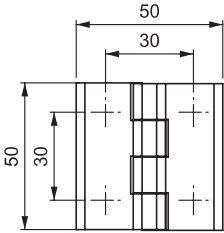

- Generally used for plain/flush-mounted doors
- Stud versions fitted with M6 x 12 mm threaded stud
- Stainless steel (AISI 304) hinge pin.
- Maximum hinge rotation 270°

APPLICATIONS

Electric panels, built-in covers

MATERIAL

BODY: Polyamide DIN-EN ISO 1043-1 PA 6 GFR 30  
PIN: Stainless Steel

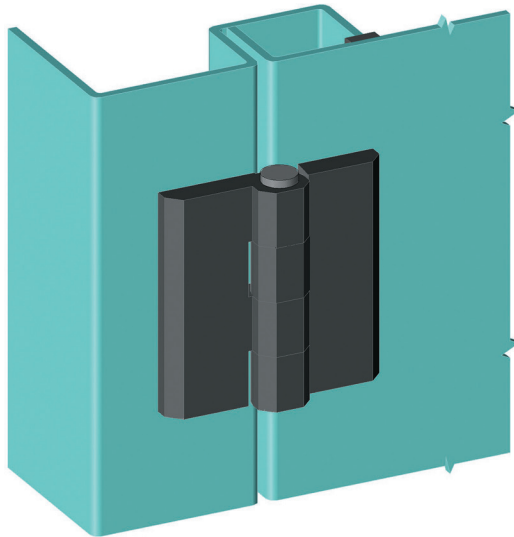

PRODUCT CODE

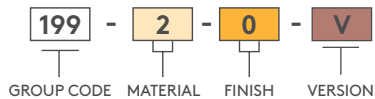

MATERIAL	M	FINISH	F
Plastic	2	No finish	0

Hinge Rotation Angle

